

Maldives Land and Survey Authority,
 MINISTRY OF HOUSING AND INFRASTRUCTURE
 Ameenee Magu, Maafannu, Male', 20392, Maldives.
 Office (PABX): +(960) 3004300, Fax: +(960) 3004254
 Email: survey@housing.gov.mv
 Web: www.surveyofmaldives.gov.mv, www.housing.gov.mv



CONTROLPOINT DETAILS	Station Number	PSM 0001
Coordinate Information		
Geodetic	Grid	
WGS 84	UTM Zone 43	
Lat: 4°15'34.91271"N	E: 320290.350	
Long: 73°22'50.75648"E	N: 471021.972	
Ellp Height: -91.898m	Orth Height: +1.008m	
Island Name: K.KOHDHIPPARU	Date:	25 MAY 2017

Monument description & method of survey:





- Monument Type A as in Technical Brief
- Stainless steel plate fixed to concrete by Four bolts
- Horizontal coordinates fixed by GNSS Static survey.

General site condition & access:

- Easily accessible area with wide angle of sky visibility
- Located in the main jetty

NOTE : Previously established PSM's have been relocated and these are the new coordinates derived from a Static Survey

Owner: Grand Park Kohdhipparu, Maldives

		
Bottom	North Height 1.6m / Distance 3m	East Height 1.6m / Distance 3m
		
Up Height 1.6m	South Height 1.6m / Distance 3m	West Height 1.6m / Distance 3m

SITE INFORMATION

Station Number

P	S	M	0	0	0	1
---	---	---	---	---	---	---

Station Horizon Mask

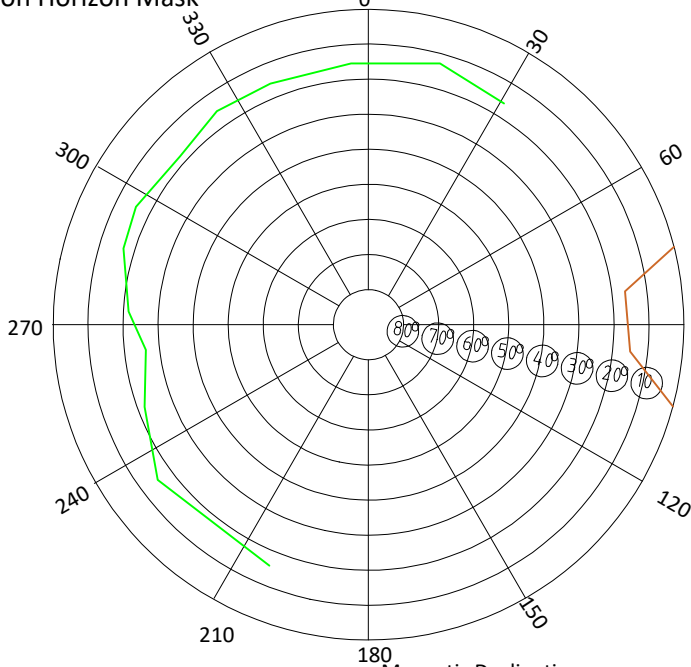

Locality



Height above Marker that horizon was mapped from 1.5 m

Magnetic Declination _____
 Declination applied to this figure?
 Yes No

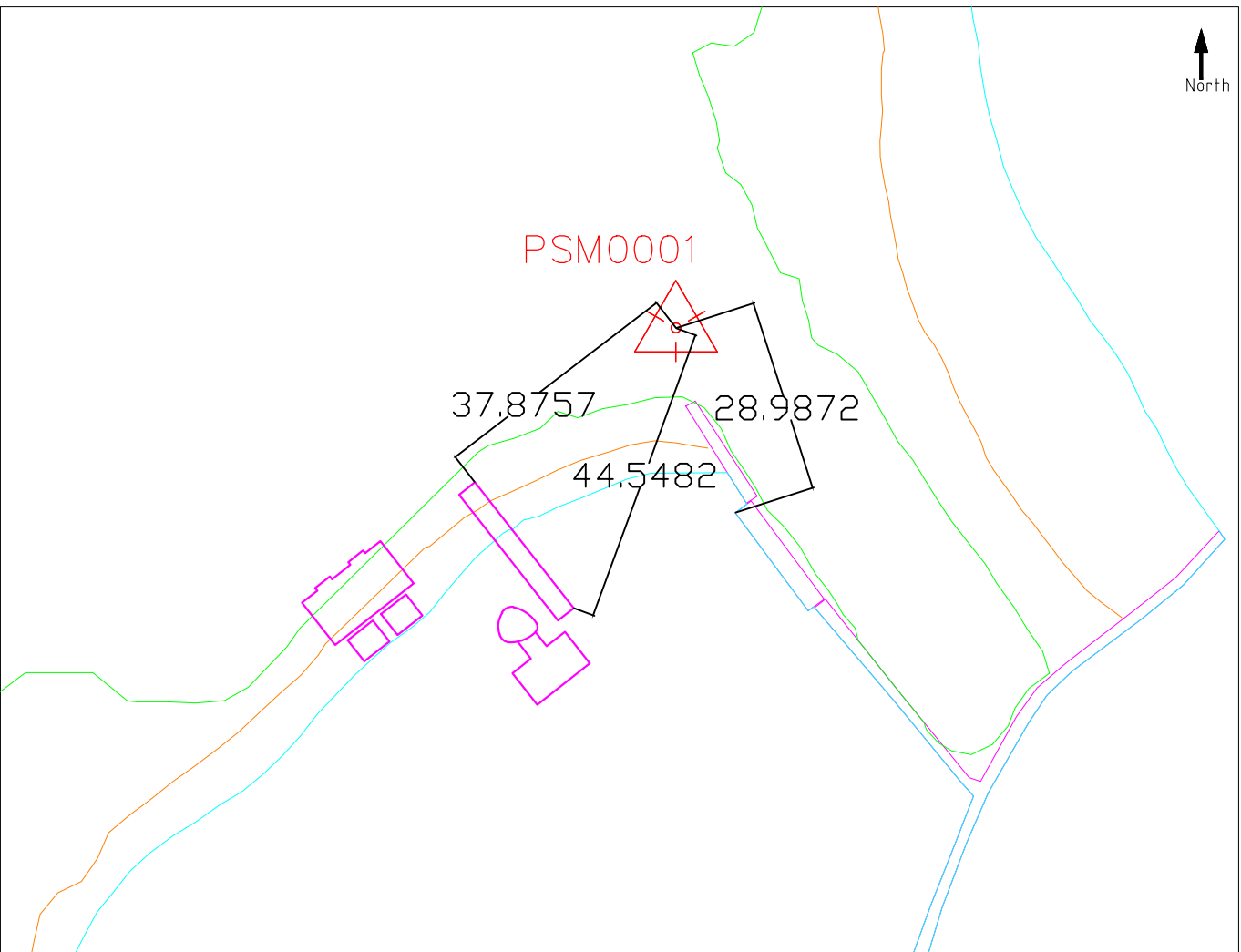

Sketched by: Abulho

Scale:

Date: MAY 2017

Maldives Land and Survey Authority,
 MINISTRY OF HOUSING AND INFRASTRUCTURE
 Ameenee Magu, Maafannu, Male', 20392, Maldives.
 Office (PABX): +(960) 3004300, Fax: +(960) 3004254
 Email: survey@housing.gov.mv
 Web: www.surveyofmaldives.gov.mv, www.housing.gov.mv



CONTROLPOINT DETAILS	Station Number	PSM 0002
Coordinate Information		
Geodetic	Grid	
WGS 84	UTM Zone 43	
Lat: 4°15'30.50725"N	E: 320171.618	
Long: 73°22'46.91542"E	N: 470886.899	
Ellp Height: -91.432m	Orth Height: +1.482m	
Island Name: K.KOHDHIPPARU	Date: 25 MAY 2017	

Monument description & method of survey:

- Monument Type A as in Technical Brief
- Stainless steel plate fixed to concrete by Four bolts
- Horizontal coordinates fixed by GNSS Static survey.
- PSM 0002 is 200mm above ground Level

General site condition & access:

- Easily accessible area with wide angle of sky visibility
- Located near Restaurant

NOTE : Previously established PSM's have been relocated and these are the new coordinates derived from a Static Survey

Owner: Grand Park Kohdhipparu, Maldives

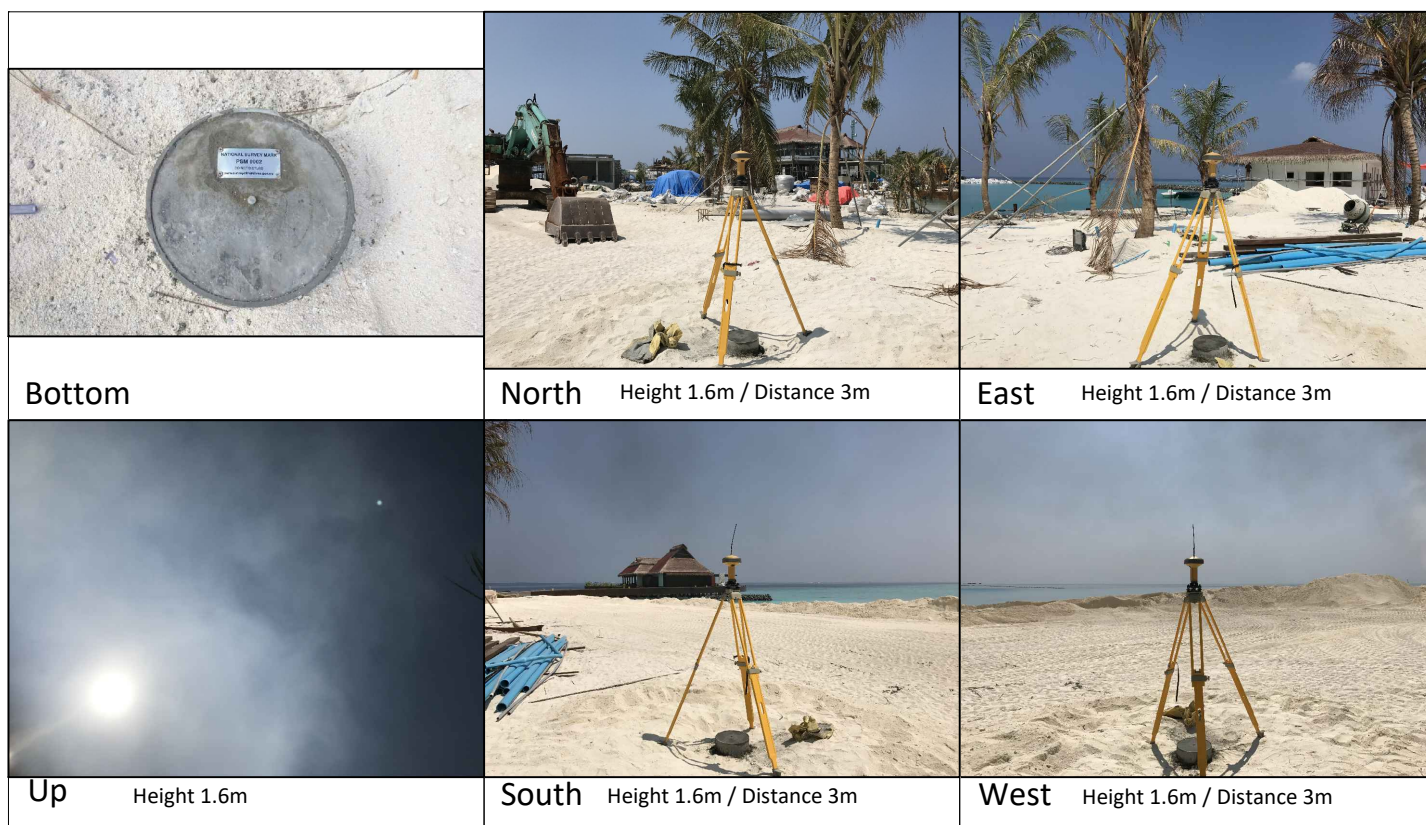

SITE INFORMATION

Station Number

P	S	M	0	0	0	2
---	---	---	---	---	---	---

Station Horizon Mask

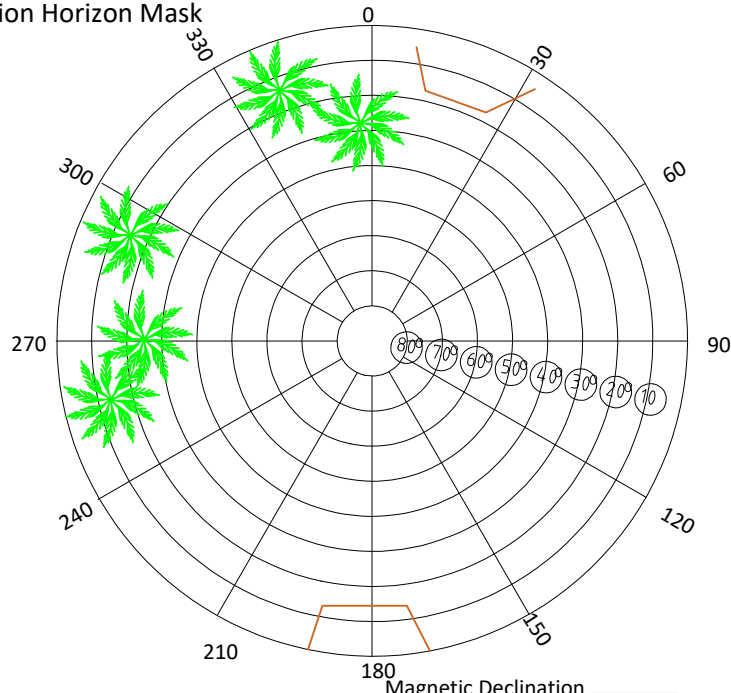

Height above Marker that horizon was mapped from 1.5 m

Magnetic Declination _____
 Declination applied to this figure?
 Yes No

Locality

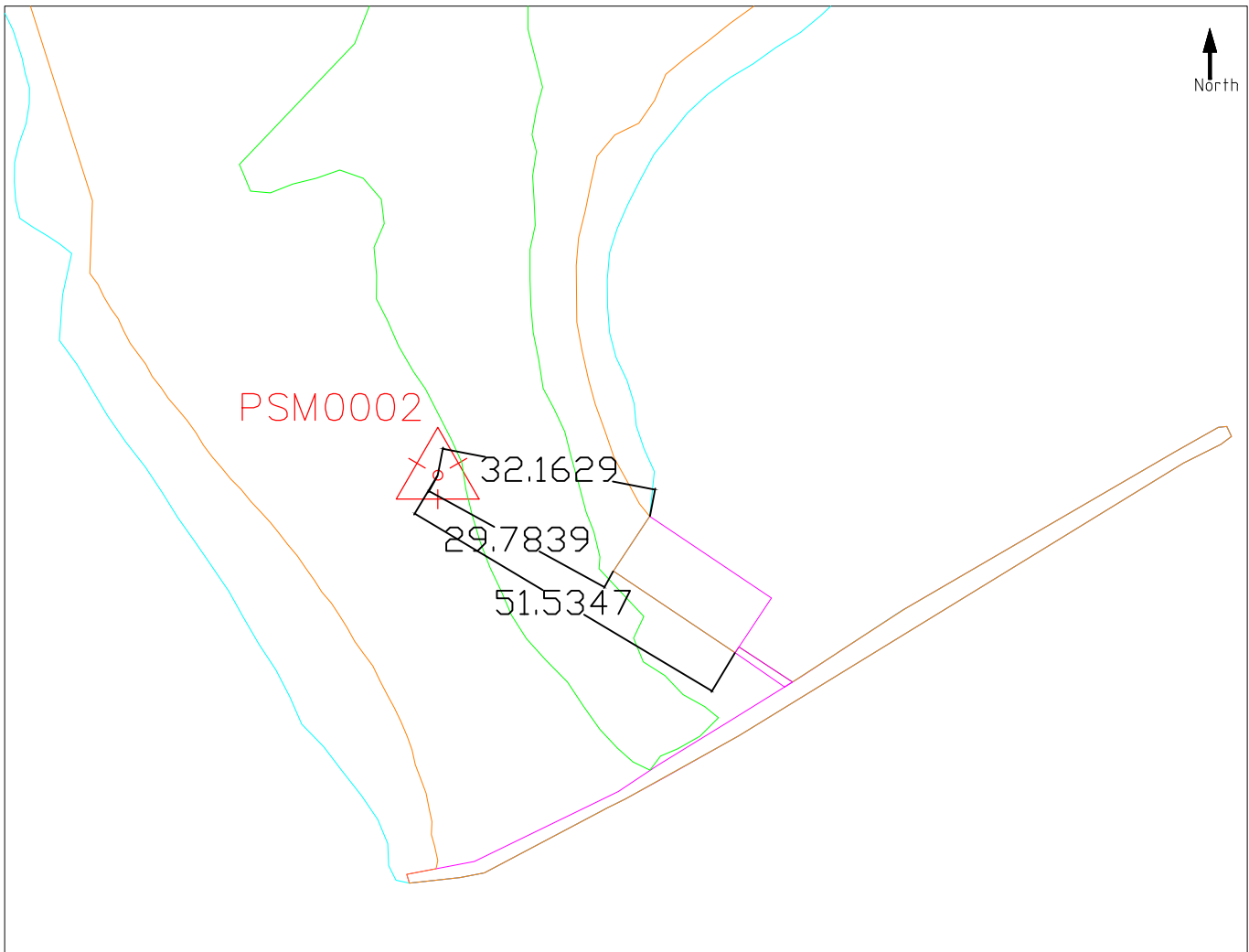

Sketched by: Abulho

Scale:

Not to Scale

Date: MAY 2017



CONTROLPOINT DETAILS	Station Number	PSM 0003
Coordinate Information		
Geodetic	Grid	
WGS 84	UTM Zone 43	
Lat: 4° 15' 36.25035" N	E:	320124.791
Long: 73° 22' 45.38488" E	N:	471063.408
Ellp Height: -92.028m	Orth Height:	+0.886
Island Name: K.KOHDHIPPARU	Date:	25 MAY 2017

Monument description & method of survey:

- Monument Type A as in Technical Brief
- Stainless steel plate fixed to concrete by Four bolts
- Horizontal coordinates fixed by GNSS Static survey.
- Elevation reduced relative to Local MSL by double level run
- PSM 0003 is 50mm above ground Level

General site condition & access:

- Easily accessible area with wide angle of sky visibility

NOTE : Previously established PSM's have been relocated and these are the new coordinates derived from a Static Survey

Owner: Grand Park Kohdhipparu, Maldives



SITE INFORMATION

Station Number

P	S	M	0	0	0	3
---	---	---	---	---	---	---

Station Horizon Mask

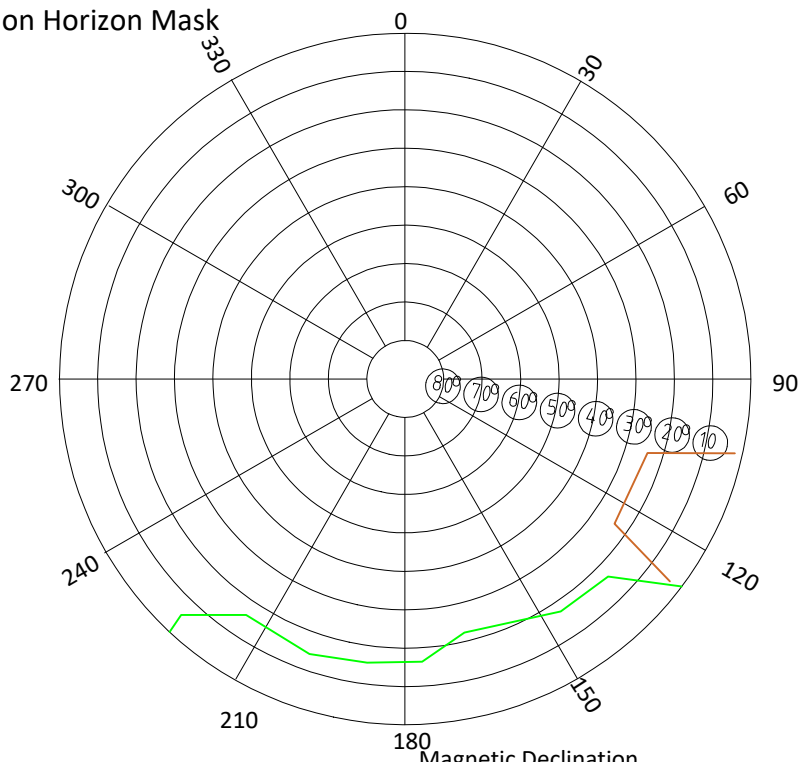

Height above Marker that horizon was mapped from 1.5 m

Magnetic Declination
 Declination applied to this figure?
 Yes No



Locality

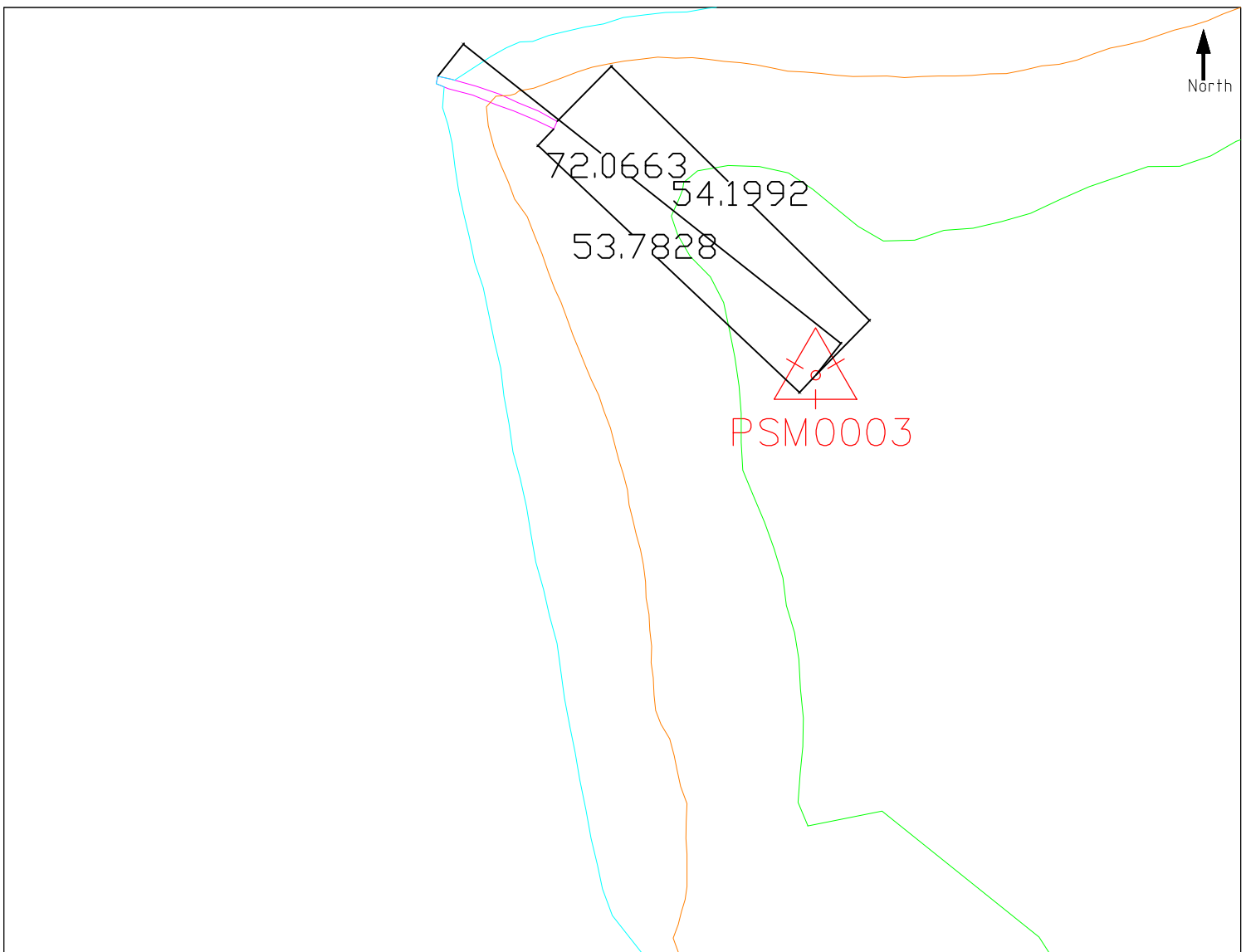
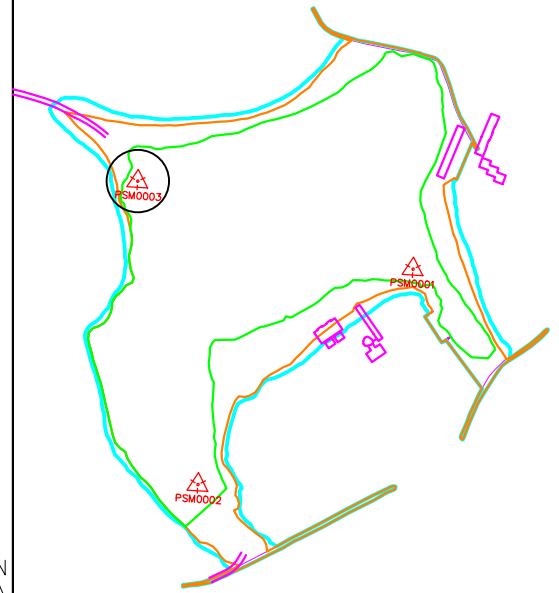

Sketched by: Abulho

Scale:

Not to Scale

Date: MAY 2017